

A N U B H A V A CULTURAL EXPERIENCE

Rani ki vav, a testament to Queen Udayamati's benevolence, originally crafted for the well-being of the community. Over time, however, its purpose faded, reduced to a spectacle for those from afar.

The transformation envisions breathing life back into this dormant well as a Cultural Center. Picture workshops echoing with the rhythmic clatter of looms, embracing local artisans like the skilled patola weavers, clay whispering through the hands of potters, and the meticulous creation of hand crafted jewelry during their off-season.

Amidst the vibrant hum of creativity, a tranquil haven for people to find solace, with the echoes of history mingling with the present. Tourists, drawn not just by the architectural marvel but by the beating heart of a living culture and embark on a journey where the well, once forgotten, fulfills its destiny – a haven for the people, as the Queen had envisioned.

CULTURAL SANCTUM

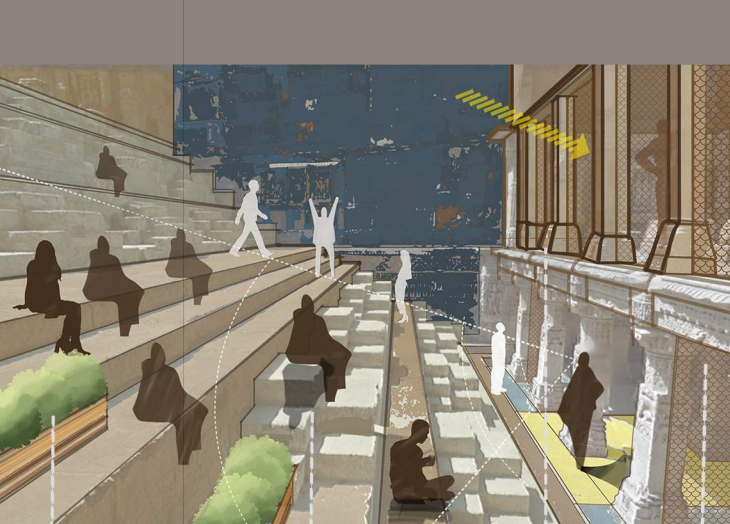

Planter
Seating stairs
Exhibition wall
Jali wall

1 Amphitheatre like space created with stepped seating facing bottom pavilion which can be used for lectures and talks.

2 The central spiral stairs aids in vertical circulation bridges to exit the site and ramps below for horizontal circulation in site. It is stiffened by tensile chords, anchored at the ground level.

Tensile
Ramp Cables Ramp Stairs Bridge Anchors

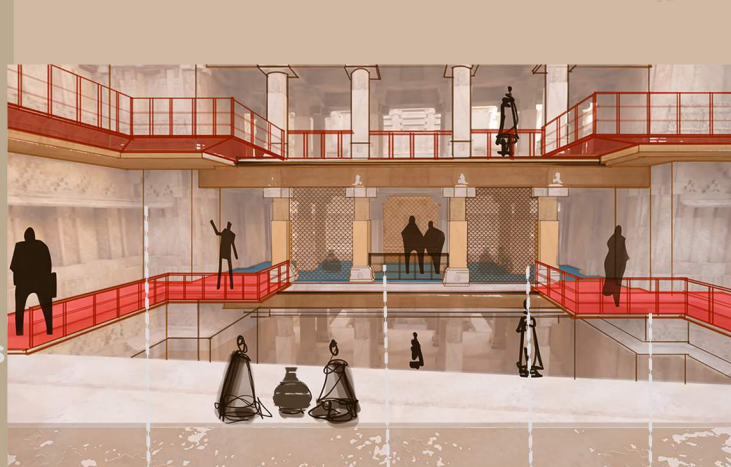
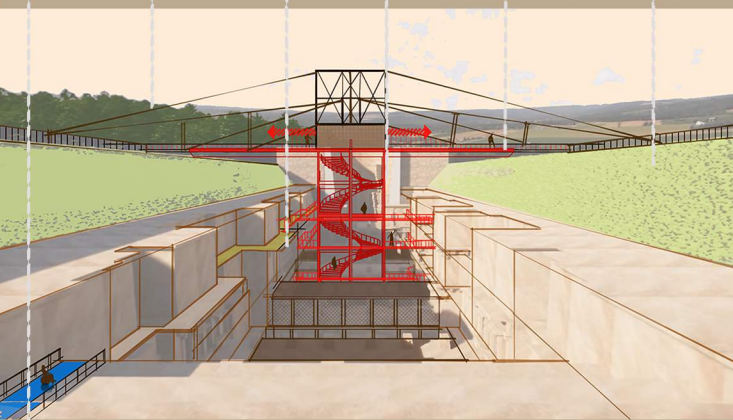

Railing
Work space
Jali
Ramp

3 The pavilions are used as workshop area for different crafts seasonally. These contain seismic dampers at the column beam junction.

4 Skylights are provided above the meditation centre to not only create sound barrier from workshops but also to allow diffused light underneath.

Ramp
Extended space
Skylight

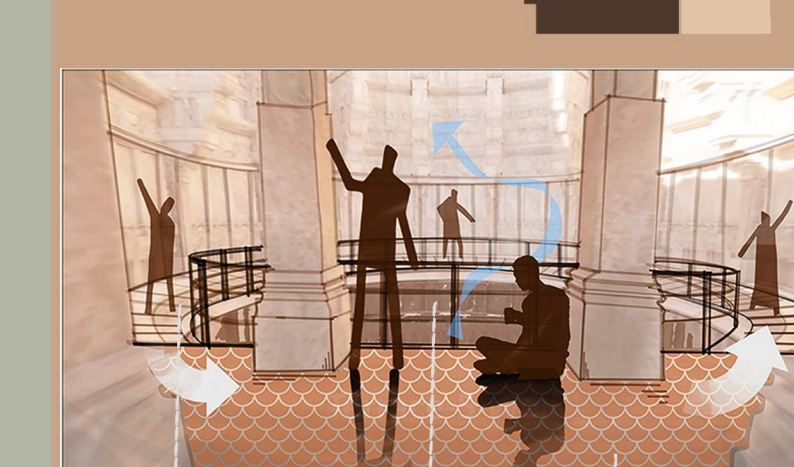

Circulation around well
Well
Workshop space

5 The observation deck along the circular well allows people to observe and admire the intricate carvings of the well, while onlooking the waterfall below.

LOCATION

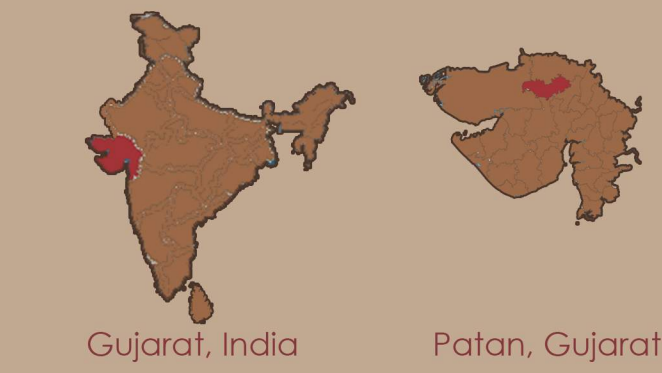

SITE PLAN

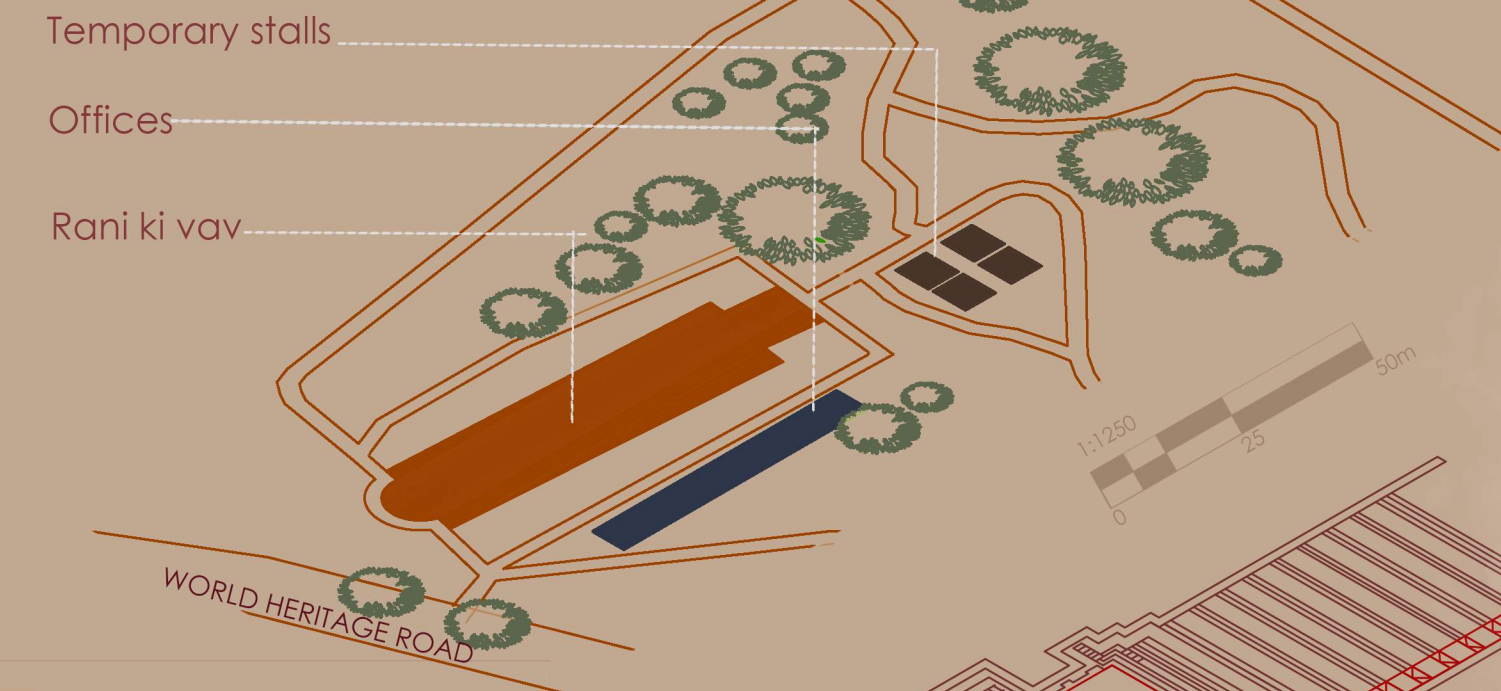

CHALLENGES IN EXISTING STRUCTURE

- No ramps.
- No means of vertical circulation.
- Unpleasant odour due to still water.
- Seismic activity.

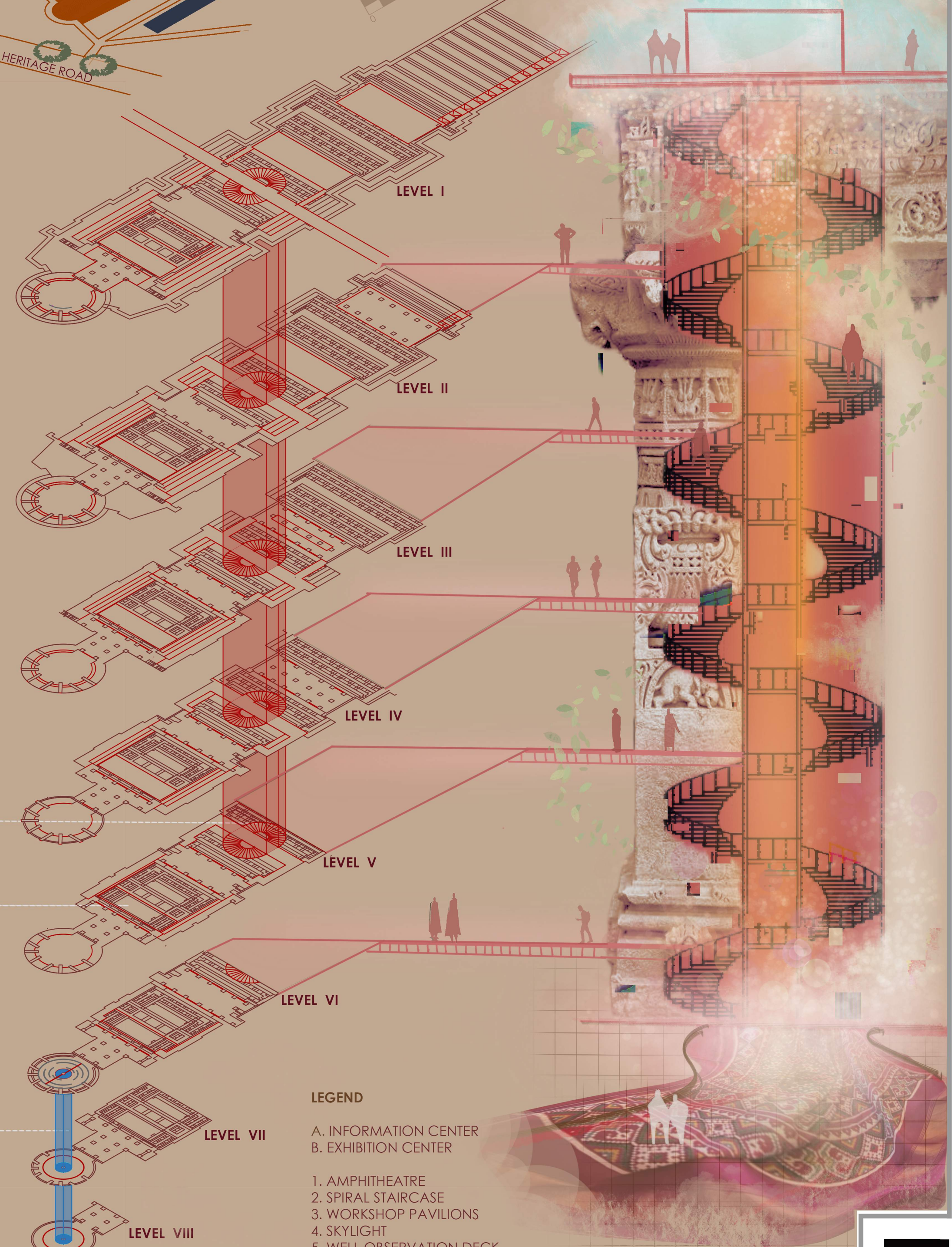

LEGEND

- A. INFORMATION CENTER
- B. EXHIBITION CENTER
- 1. AMPHITHEATRE
- 2. SPIRAL STAIRCASE
- 3. WORKSHOP PAVILIONS
- 4. SKYLIGHT
- 5. WELL OBSERVATION DECK
- 6. MEDITATION CENTER

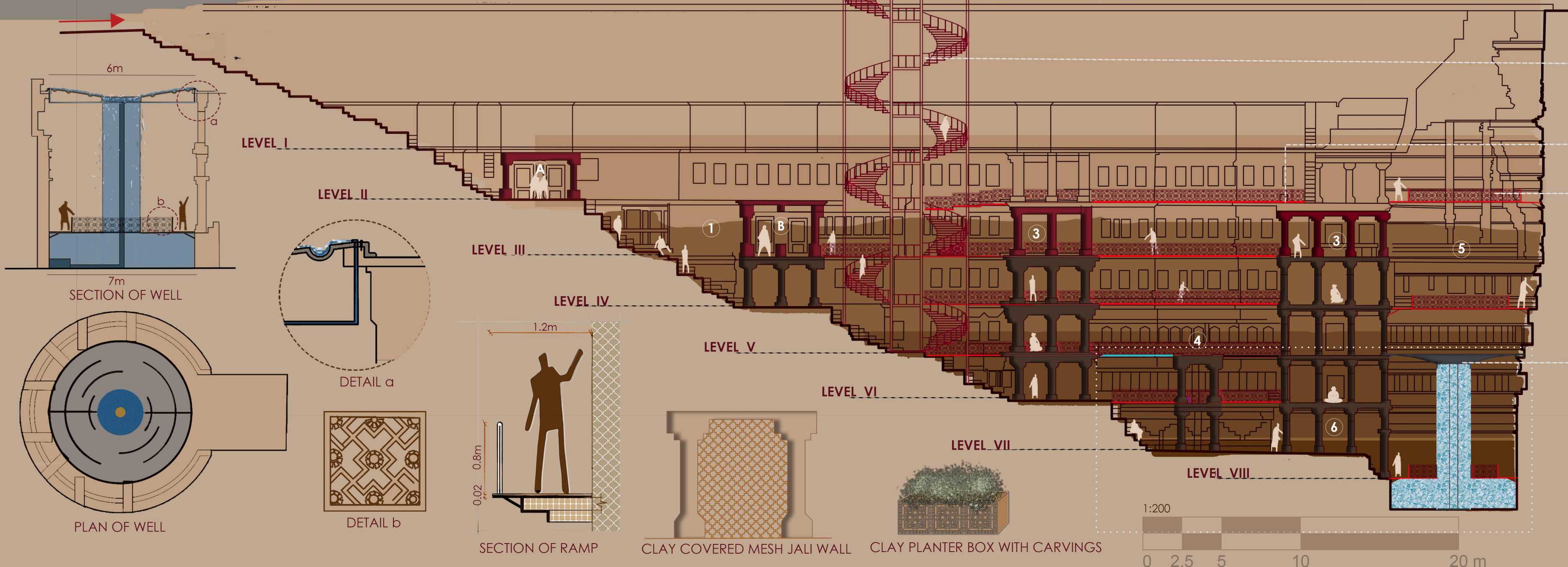

Stairs for vertical circulation and quick exits
Ramps
Railings

Water falls

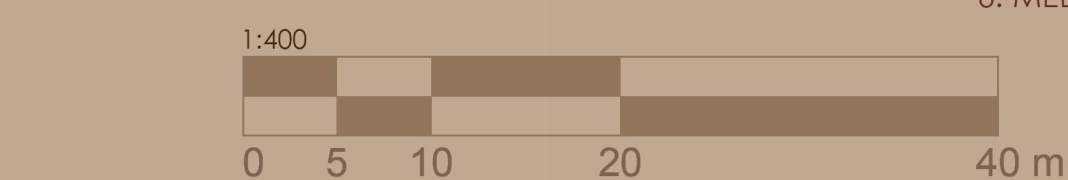

CPK TROPHY 2023-24

Registration code:
66CPK-202

